

**WARNING TS204**

The tail rotor in this diagram is shown in the optional (right) side of the helicopter. The tail rotor should be mounted on the left handed side. If you choose to mount the tail rotor on the right side of the helicopter, it is absolutely critical that you use RED LOCTITE on the threads. The threads are left handed and the tail rotor hub could spin off if mounted on the right side of the helicopter if not installed properly using red loctite.

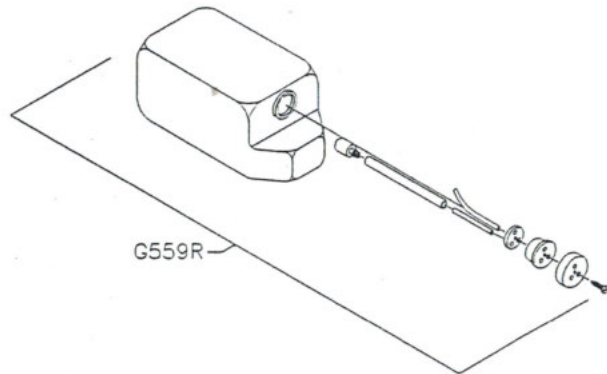

G559R

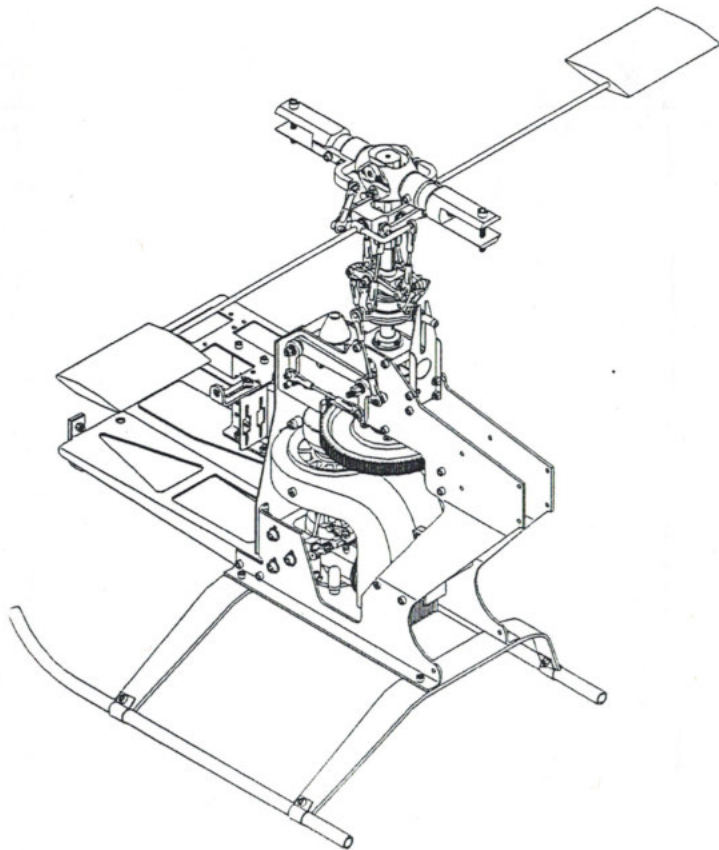
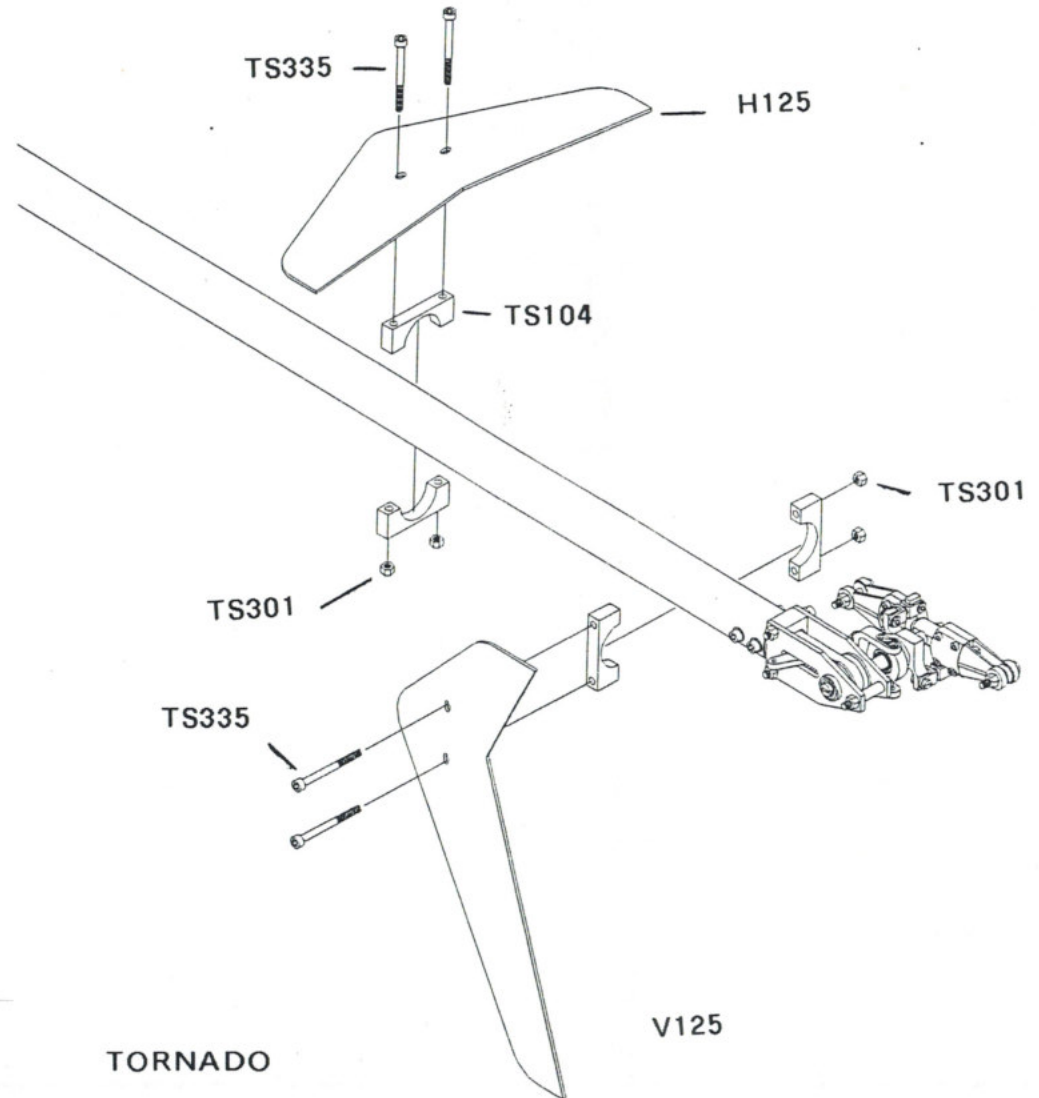

TORNADO

V125